

RECLAMATION PLAN

HALF OF OVERBURDEN SOIL TO BE SOLD DURING MINE OPERATION. OTHER HALF OF OVERBURDEN TO BE USED TO FILL THE TAILING PONDS, ALL SKIMMER BASINS, AND THEN EQUALLY SPREAD AND COMPACT REMAINING SOIL OVER GRAVEL PLANT AND STOCKPILE AREAS.

NOTE:

THE TEMPORARY CROSSING & ALL OTHER EROSION CONTROL MEASURES WILL BE REMOVED AND THE ASSOCIATED AREAS WILL BE ADEQUATELY STABILIZED BY SEEDING & MULCHING.

Paul A. Stimpson
NORTH CAROLINA PROFESSIONAL ENGINEER
PAUL A. STIMPSON
22052
4/9/20

© 2019 LaBella Associates

**ALAMANCE
AGGREGATES, LLC**

Mr. Chad Threatt, VP

Snow Camp Mine

NO.	DATE	NCDEMLR COMMENTS	DESCRIPTION
1	3/31/20		

PROJECT NUMBER: 2190335

DRAWN BY: KCG/ATC/BWS

REVIEWED BY: PAS

ISSUED FOR: CONSTRUCTION

DATE: 4/9/20

DRAWING NAME:

RECLAMATION PLAN

DRAWING NUMBER:

C204

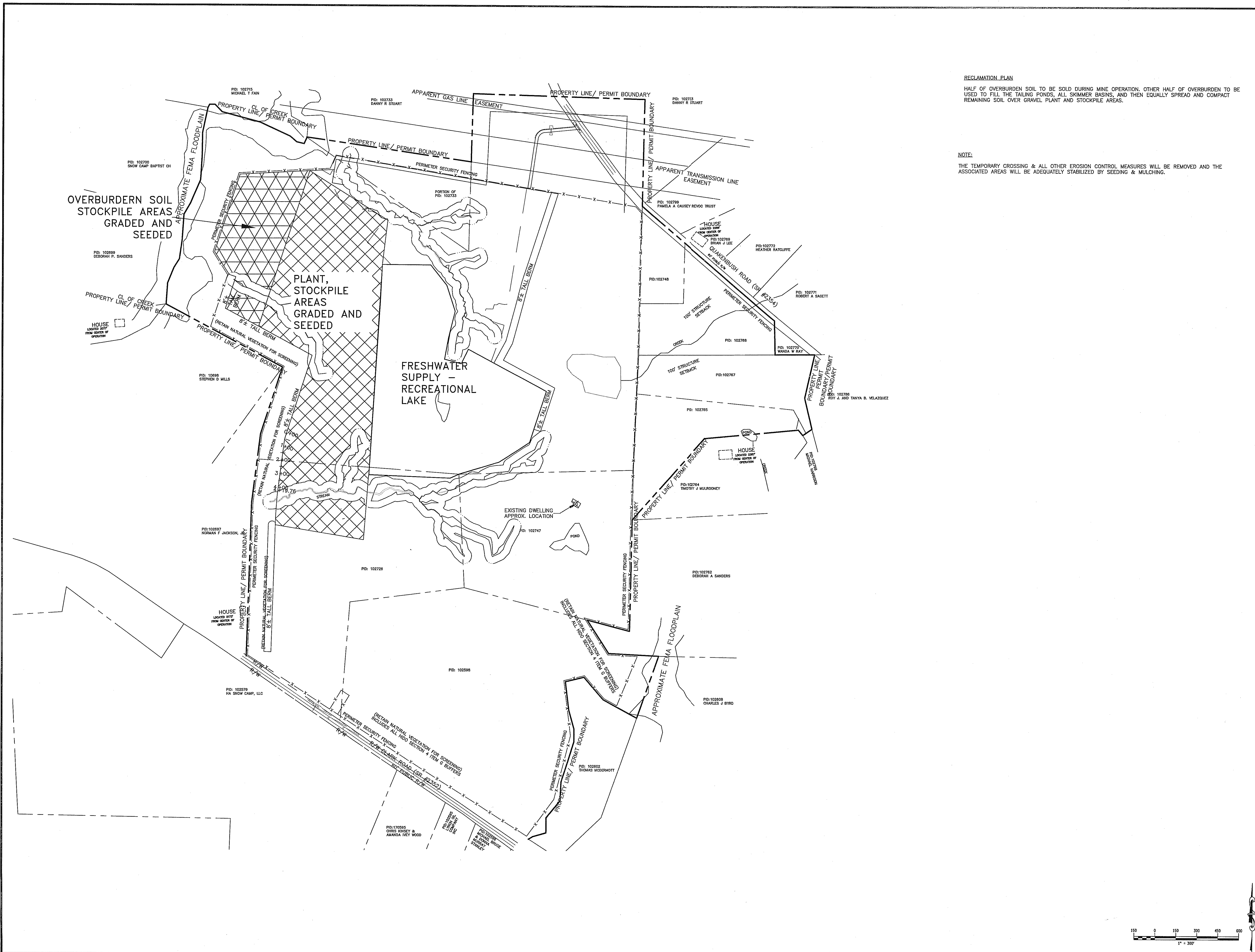
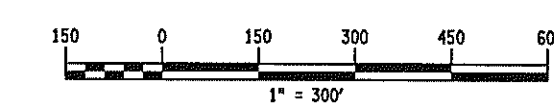

Date & Time: 4/9/2020 8:56 AM By: Sherill, Brandon
File: Y:\2190335-Snow Camp Mine\CD\DWG\CD\2190335-Snow Camp Plan Sheets.dwg