

ALAMANCE QUARRY & CONSTRUCTION MATERIALS

342 CLARK ROAD
SNOW CAMP, NC 27349
ALAMANCE COUNTY, NC

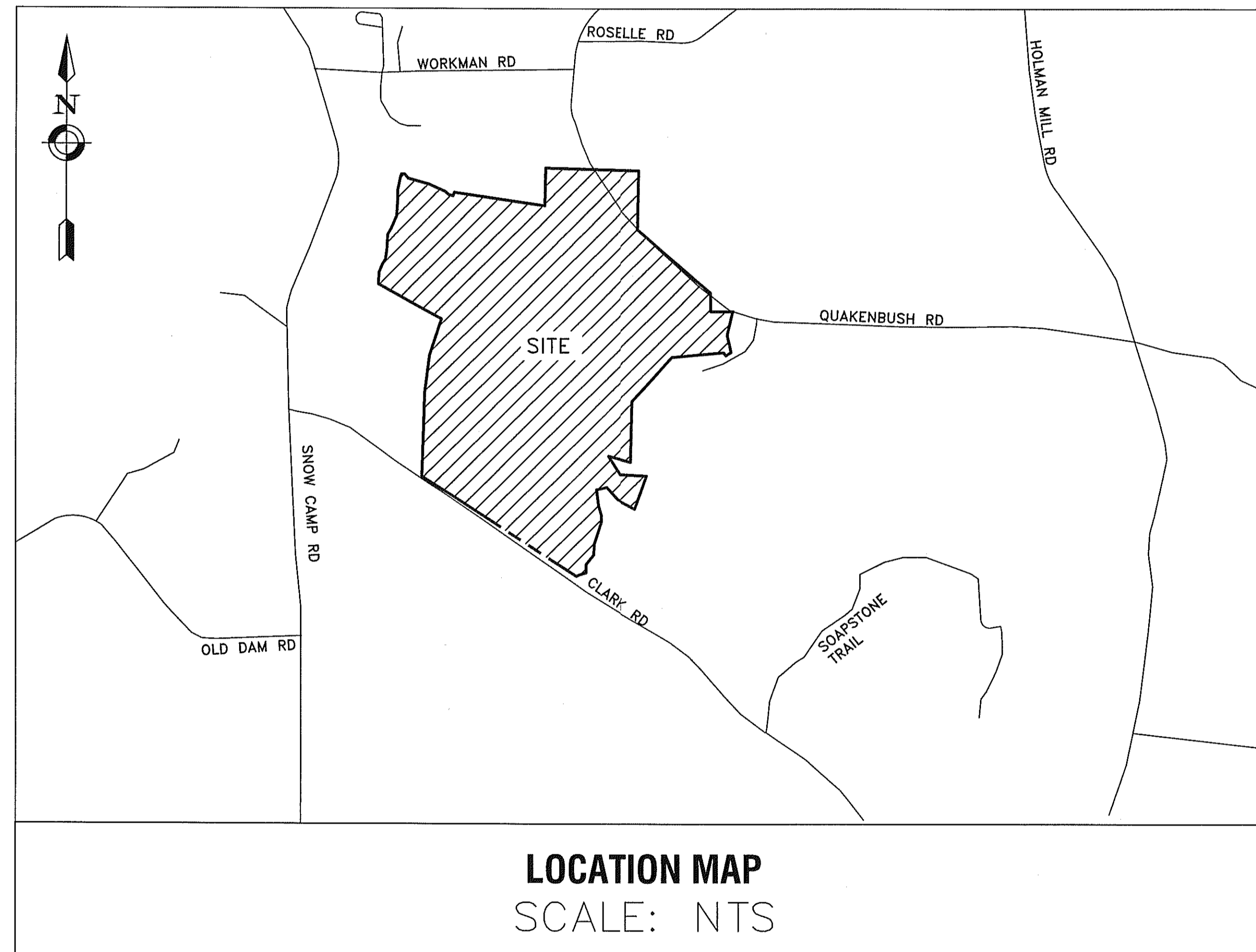

SHEET INDEX

- COVER SHEET
- C101 EXISTING CONDITIONS
- C201 MINE MAP
- C202 PLANT AND STOCKPILE PLAN
- C203 MINE PLAN
- C204 RECLAMATION PLAN
- C301 OVERALL SEDIMENTATION & EROSION CONTROL PLAN
- C301A – C301F 1"=60' EROSION CONTROL PLANS
- ~~C302 SKIMMER BASIN GRADING (SHEET DELETED)~~
- C303 ENTRANCE ROAD PLAN AND PROFILE
- C304 DRAINAGE AREAS
- C305 PARKING AND ENTRANCE ROAD DETAILS
- C401 SITE DETAILS
- C402 SITE DETAILS
- C403 SITE DETAILS
- C501 EROSION AND SEDIMENT CONTROL DETAILS
- C502 EROSION AND SEDIMENT CONTROL DETAILS

SITE DEVELOPER/OWNER

ALAMANCE AGGREGATES, LLC

Paul A. Stimpson
NORTH CAROLINA
PROFESSIONAL
ENGINEER
22052
PAUL A. STIMPSON
4/9/2020

REVISION NO: 1 DATE: 3/31/20 DESCRIPTION: NCDENR COMMENTS & SHEET C302 DELETED



615 St. George Square
Suite 300
Winston-Salem, NC 27106
336-842-4065
C#0430
labellapc.com
PROJECT NO: 2190335