

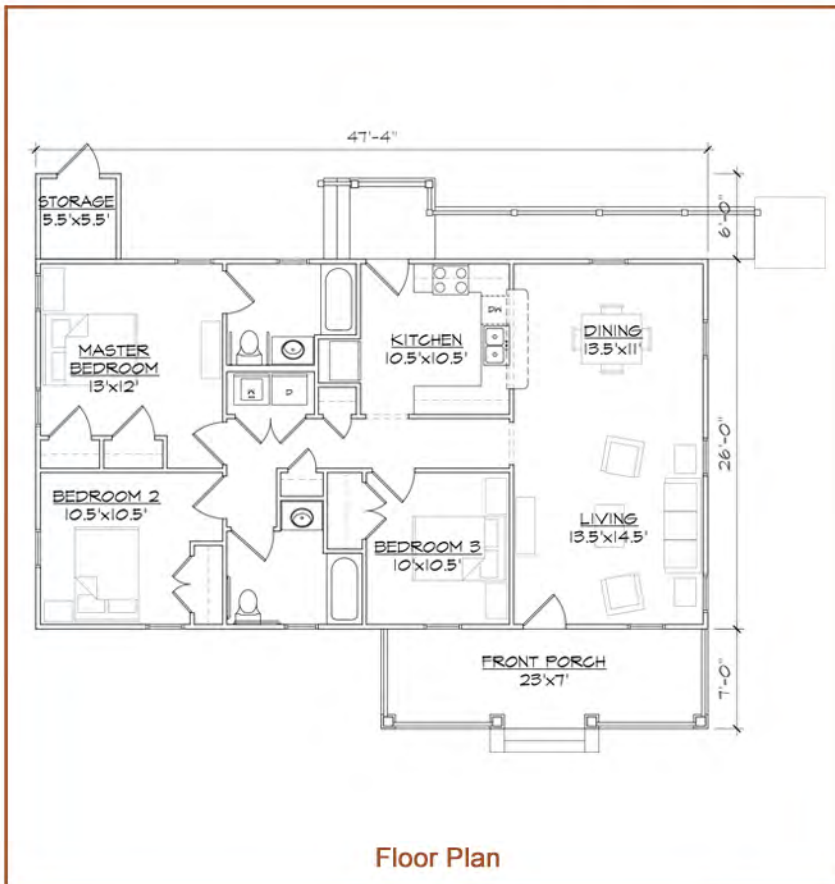

Haywood II Ranch



This single story ranch style home of 1231 square feet has been thoughtfully designed to allow for handicapped accessibility. It features a large open living and dining area and a private master bedroom suite. This open floor plan includes a total of three bedrooms, two full bathrooms and a U-shaped kitchen with breakfast bar. The home offers a laundry closet and a convenient rear entry accessible by an optional ramp that enters into the kitchen. A five foot turning radius is provided in the bathroom, kitchen and side entry. The historically inspired exterior offers a gabled roof and large covered front porch.

square footage	1231 sq ft
bedrooms	3
bathrooms	2
width	47'4"
depth	33'0"
roof pitch	6/12



Haywood II Ranch



FRONT ELEVATION



RIGHT ELEVATION



LEFT ELEVATION



REAR ELEVATION